

TOPSOIL NOTE:
 THE CONTRACTOR SHALL STRIP ALL OF THE AVAILABLE TOPSOIL WITHIN THE LIMITS OF CONSTRUCTION, APPROX. 5 INCHES DEEP. STOCKPILE THE MATERIAL AND REPLACE THE TOPSOIL ON FINISHED SLOPES OF THE GRADING SECTION. ALL ADDITIONAL COSTS NOT COVERED IN OTHER ITEMS SHALL BE INCLUDED IN THE LUMP SUM TOPSOIL ITEM AS FOLLOWS:

EXCAVATION SECTION
 THE VOLUME OF TOPSOIL IS INCLUDED IN THE UNCLASSIFIED EXCAVATION QUANTITIES. CONTRACTORS ARE TO INCLUDE ANY ADDITIONAL COSTS TO REMOVE, STOCKPILE AND REPLACE THE MATERIAL ON THE FINISHED GRADING SLOPES, IN THE LUMP SUM TOPSOIL ITEM.

EMBANKMENT SECTIONS
 DETERMINE THE AMOUNT OF TOPSOIL IN THESE AREAS AND INCLUDE ALL COSTS TO REMOVE, STOCKPILE AND REPLACE THE MATERIAL ON THE FINISHED GRADING SLOPES, IN THE LUMP SUM TOPSOIL ITEM.

OKLAHOMA DEPARTMENT OF TRANSPORTATION					
FED. ROAD DIST. NO.	STATE	STATE JOB NO.	FISCAL YEAR	SHEET NO.	TOTAL SHEETS
4	OKLA	17020(05)		X1	
DESCRIPTION		REVISIONS		DATE	

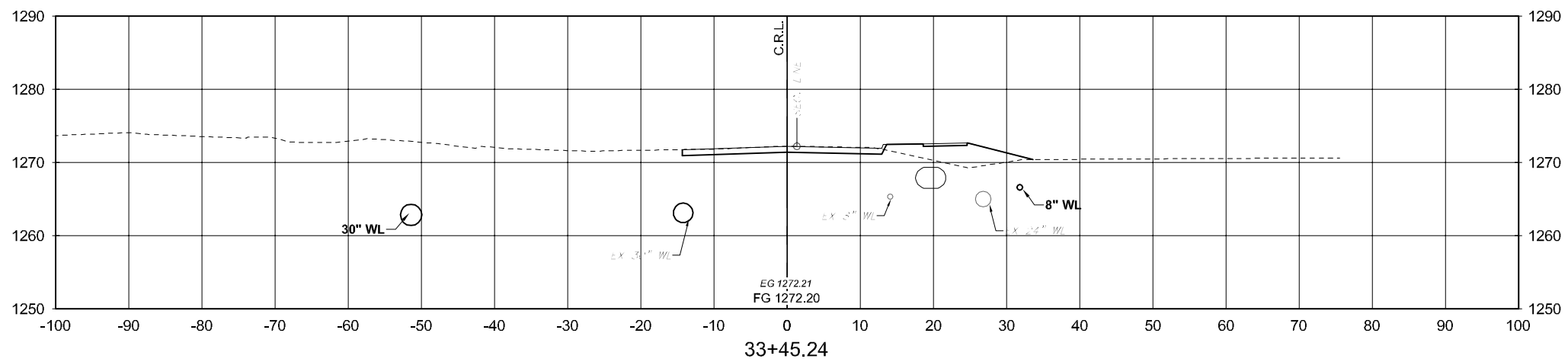
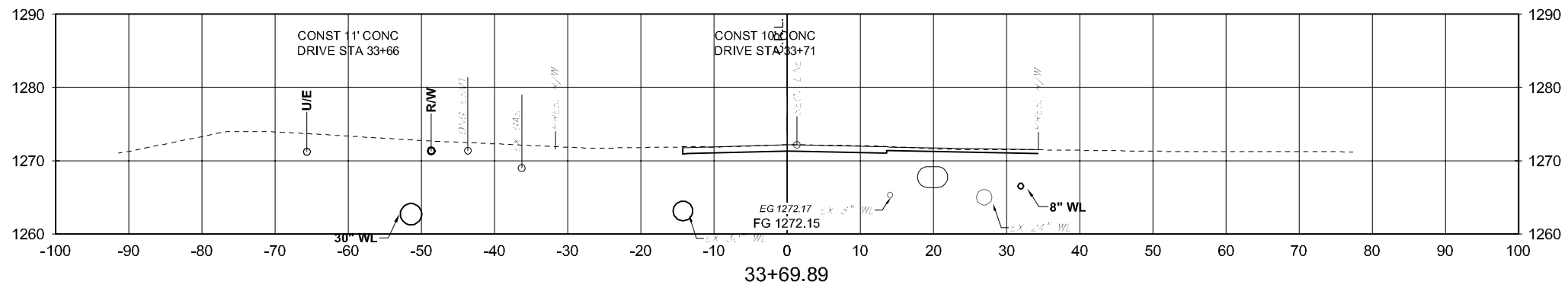
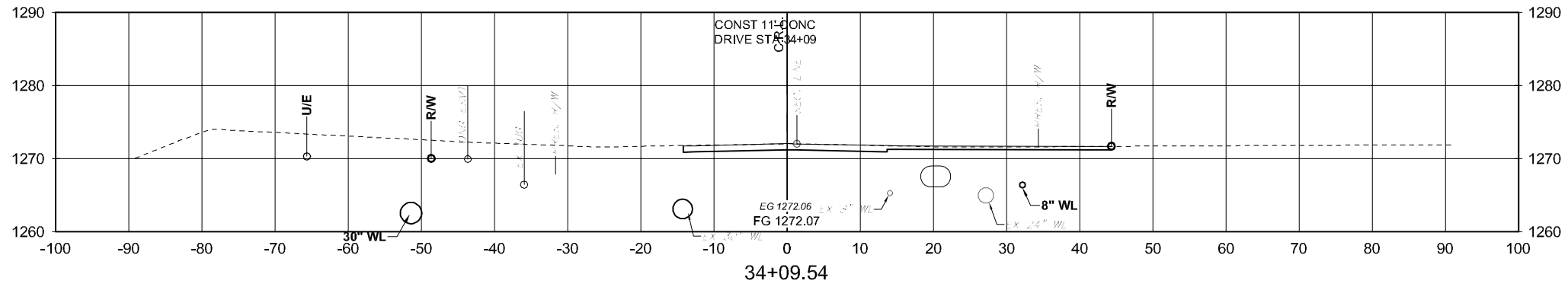

UTILITIES SHOWN ON CROSS SECTIONS ARE SHOWN AT ESTIMATED LOCATIONS. EXACT DEPTHS AND DISTANCES ARE UNKNOWN.

4/18/2017 1:38:34 PM - P:\27712\131-27712-1300\1\CADD\SHETS\FILES\SECTIONS\CHESTNUT.DWG -SCHUMACHER, MIKE